

This HowTO should be used when removing the door from your CS Cavity Slider.

For doors that < slide > inside walls

1 Remove head jamb (if fitted) (drawing A and B)

The head jamb must first be removed so that access may be gained to the carriages.

Choose the best side to remove the door from (drawing B) and remove head jamb by first removing any architraves.

Remove the wooden plugs covering the screw heads. Remove the screws holding the head jamb in place, then gently tap jamb to remove.

Hint: Make a thin knife cut where any paint joins two components so as not to tear existing paint work.

A TRACK CROSS SECTION

See point 1.

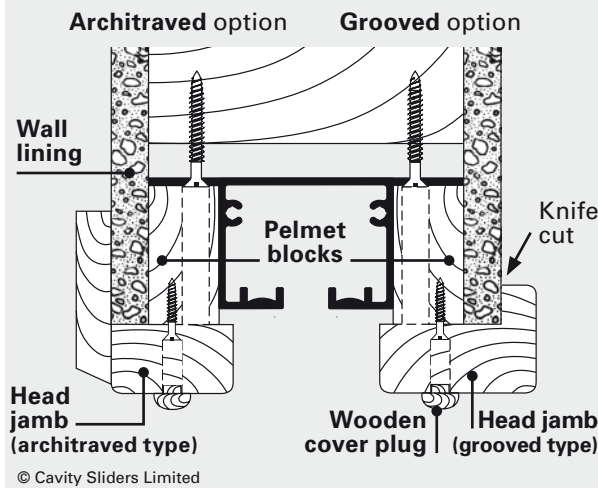

2 Remove door from track (drawing B & C).

Slide the extended end of the spanner supplied down the threaded part of the hanger shaft of the CarriSnap carriage (drawing C). Make sure extended end points in same direction as the curved release pin.

Fit it over the hexagonal nut at the bottom.

Now, (with the extended part of the spanner) press down the curved release pin that points up from the mounting plate.

Once this pin is fully depressed you can slide the spanner sideways in the direction of that pin. You will see that the whole carriage, plus the shaft, comes loose from the mounting plate.

It is not always easy to slide the spanner sideways. You could relieve the weight of the door a little by putting a thin wedge between door and floor.

Now do the same with the second carriage. You can now remove the door (drawing B).

B DOOR REMOVAL

See points 1 and 2.

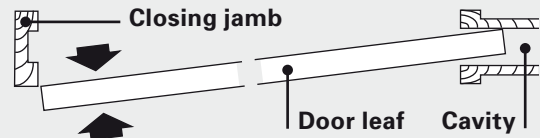

© Cavity Sliders Limited

3 Bi-Parting units (drawing C).

Follow instructions above, then remove the black plastic stop that is tightly fitted into the mounting plate at the front of each door leaf by tapping it out in the direction shown, using a hammer and drift (drawing C).

C REMOVING CARRIAGES

See points 2 and 3.

Single units

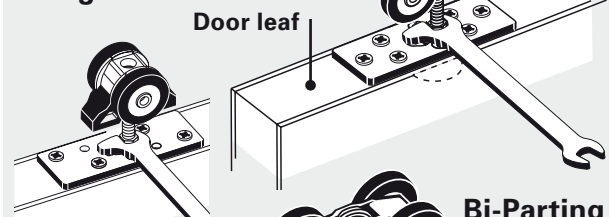

Bi-Parting units

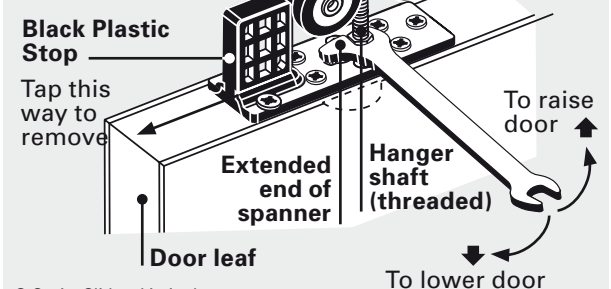

© Cavity Sliders Limited

4 Removing carriages

If you also want the carriages out: Slide them toward the notched end of the track and then take them out.

6 Replacing the door or the carriages

Follow the same steps, but in reverse order.

Drawings are not to scale.

© CS FOR DOORS and CS Cavity Sliders are Registered Trademarks. New Zealand Patent No: 533838. All copyright and other property in this document is reserved by Cavity Sliders Limited. Details and specifications are subject to change without notice. Whilst all care is taken to ensure the accuracy of all information, no responsibility will be accepted for any errors or omissions.

Quality products from:

FOR DOORS